



Designation of a travel wheel form BG with nominal- \varnothing $d_1 = 630$ mm, gauge $b_1 = 100$ mm, hub symmetric ($l_1 = l_2 = 185$ mm):

Crane wheel BG 630 × 100 DIN 15 075

- Form SK** narrow crane wheel (S) with small gear ring (K)
- Form SG** narrow crane wheel (S) with large gear ring (G)
- Form BK** broad crane wheel (B) with small gear ring (K)
- Form BG** broad crane wheel (B) with large gear ring (G)

The plain bearings are secured with setscrews toward twisting and dislocation.

Gear rings see DIN 15 082 part 1.

Material:

- Wheel body- \varnothing 200–250 C45 machined from solid
- Wheel body- \varnothing 315–1250 GE420 (GS-70) or
G42CrMo4+QT (GS-42CrMo4 V)
- Bearing G-CuSn7ZnPb (Rg 7)
- Gear ring GE300 (GS-60) or C45

Other material and dimensions on request.

Crane wheels without gear ring see DIN 15 074.

See DIN 15070 for basis of calculation for crane wheels.

Remarks to the following table:

- 1) The dimension of the gauge recess b_1 to be stated with order. For running surface profiles and correspondence of crane rails to running wheel diameter see DIN 15072.
- 2) Asymmetric hubs (diameter l_1) as per agreement.
- 3) For $l_1 = 90$ mm is a slide bearing length of $l_3 = 120$ mm to use.
- 4) For $l_1 = 125$ mm is a slide bearing length of $l_3 = 180$ mm to use.

Crane wheels with plain bearing with gear ring

DIN 15 075

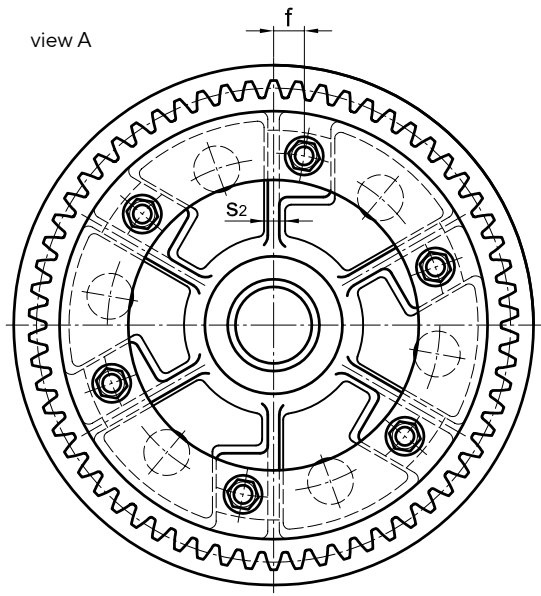
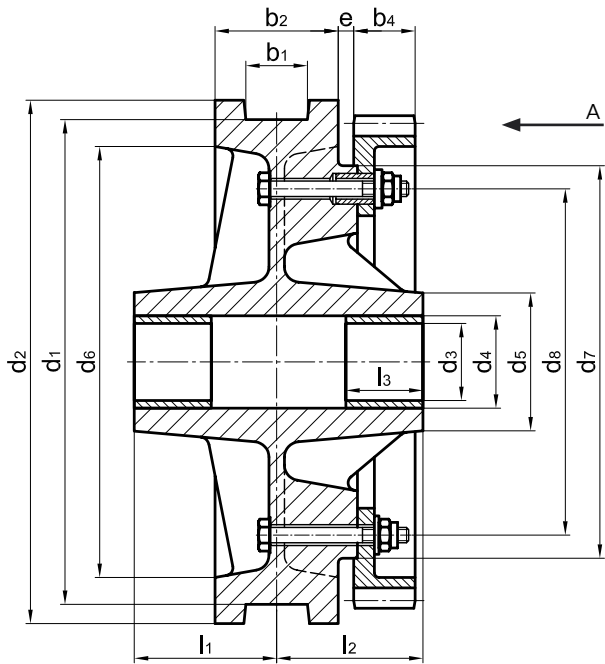

Form	d ₁ h9	b ₁ ¹⁾	b ₂	l ₁ ²⁾			l ₂	d ₂	d ₃ D10	d ₄ H7	d ₅	d ₆	d ₇ h9	d ₈	gear ring (form A)			e	f	l ₃	s ₁	s ₂	no. of ribs and cams	unit weight ^t °[kg]	
				sym- me- tric	asym- metric	Mo- du- le									no of teeth	b ₄									
SG	200	40-55	90	105	80	60	105	230	45	55	85	170	160	125	5	40	40			45				without Ribs 4	35
SG	250	40-55	90	115	85	60	115	280	50	60	100	210	200	155	5	50	50	15	-	50	18	-		58	
SG	315	45-55	90	125	95	65	125	350	60	75	120	270	260	200	6	52	60			63				76	
BG		55-65	110	135	105	75	135																		
SK	400	55-65	110	140	105	75	140	440	80	95	140	345	270	210	8	40	65	15	-	80	20	-		without Ribs 4	92
SG													300	240		50									102
BK		270	210	40	146																				
BG		300	240	50	156																				
SK	500	55-65	110	145	110	75	145	540	90	105	160	435	350	290	10	42	70	15	35	90	20	15	4	4	163
SG													390	330		49									173
BK		350	290	42	202																				
BG		390	330	49	212																				
SK	630	65-75	120	165	120	80	165	680	100	120	180	560	460	400	10	54	80	20	40	100	20	15	6	6	300
SG													510	450		62									315
BK		460	400	54	342																				
BG		510	450	62	357																				
SK	710	75-90	140	185	135	90	185	760	110	130	200	630	510	450	12	50	90	20	40	110	25	18	6	6	412
SG													580	520		58									437
BK		510	450	50	519																				
BG		580	520	58	544																				
SK	800	75-90	140	195	140	90	195	850	125	145	220	710	610	550	12	58	100	20	40	125	25	18	6	6	523
SG													660	600		66									543
BK		610	550	58	658																				
BG		660	600	66	678																				
SK	900	75-90	140	205	145	90	205	950	140	160	240	805	680	620	14	56	110	20	40	150	25	18	6	6	550
SG													750	690		63									580
BK		680	620	56	700																				
BG		750	690	63	730																				
SK	1000	75-90	140	205	145	90	205	1050	160	180	270	900	790	710	14	64	110	20	50	150 ³⁾	30	20	6	6	725
SG													840	760		70									750
BK		790	710	64	885																				
BG		840	760	70	910																				
BK	1120	95-160	220	260	190	125	260	1180	180	200	300	1010	880	800	16	62	125	20	50	180	30	20	8	8	1170
BG													950	870		68									1220
BK	1250	95-160	220	260	190	125	260	1310	200	220	330	1140	1000	920	16	70	125	20	50	200 ⁴⁾	30	20	8	8	1360
BG													1080	1000		76									1400

footnote see page 34